

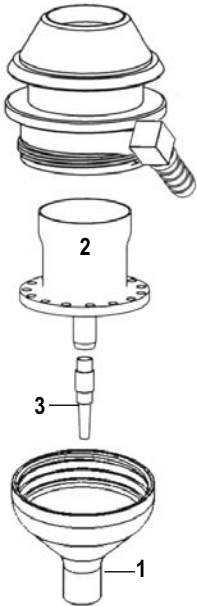

DRS MICRO & STANDARD SITE CLEANING NOZZLE & CLEANING INSTRUCTIONS

1015.11.063 Micro Nozzle



1015.11.061 Standard Nozzle

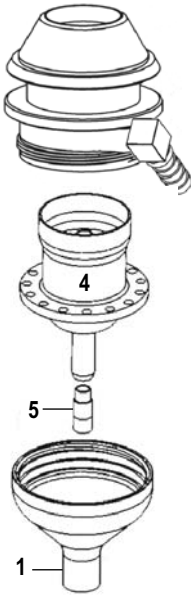

Item	Part No	Description
1	1015.11.102	Nose
2	1015.11.057	Collector Assembly
3	1015.11.127	Micro Tip (.09 x .06)
3	1015.11.136	Micro Tip (.074 x .042)
3	1015.11.134	Micro Tip (.05 x .025)
4	1015.11.055	Collector Assembly
5	1015.11.121	Large Tip (.188 x .125)
5	1015.11.122	Medium Tip (.125 x .089)
6	0001.11.101	Filter Element
7	1022.02.040	Nozzle Handling Tool
8	9008.99.982	Pliers
9	1015.11.113	Nozzle Stand
10	STB7	Brush
11	9008.99.983	Pin Vise (.0 - .04)
12	9008.99.984	Pin Vise (.05 - .125)
13	9007.99.046	Cleaning Drill (.0225 dia.)
14	9007.99.264	Cleaning Drill (.038 dia.)
15	9007.99.119	Cleaning Drill (.055 dia.)
16	9003.00.100	Cleaning Drill (.086 dia.)
17	9007.99.080	Cleaning Drill (.120 dia.)
18	9001.15.031	Cond. Silicone Hose - 21.75"
19	9001.15.031	Cond. Silicone Hose - 12.5"
20	9001.00.184	Elbow
21	0025.04.101	Clip Packaged Separately
22	9000.33.005	Tape Packaged Separately

Micro & Standard Nozzle Kit 1015.11.017

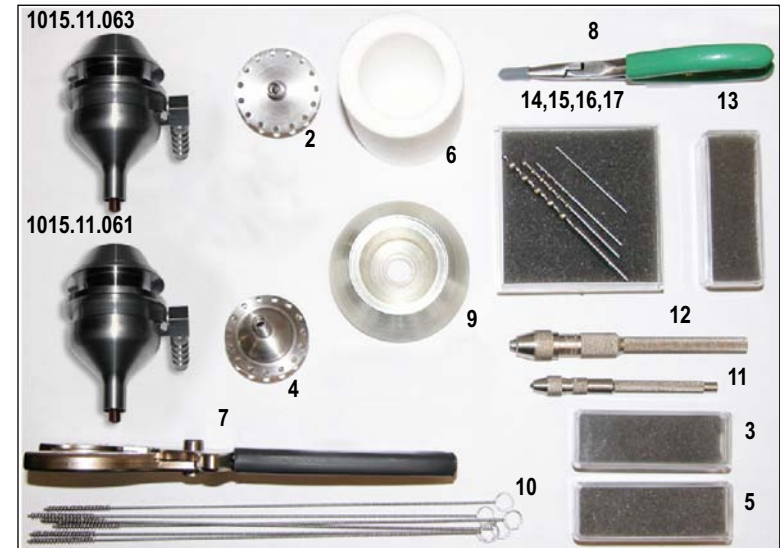

CLEANING INSTRUCTIONS

CAUTION: NOZZLE IS HOT DURING OPERATION. NOZZLE MUST BE COOL BEFORE DISASSEMBLY & CLEANING



Remove nozzle from DRS using nozzle handling tool and place in nozzle stand when not in use and prior to cleaning.

Any solder accumulation on the flat surface can be scraped off.

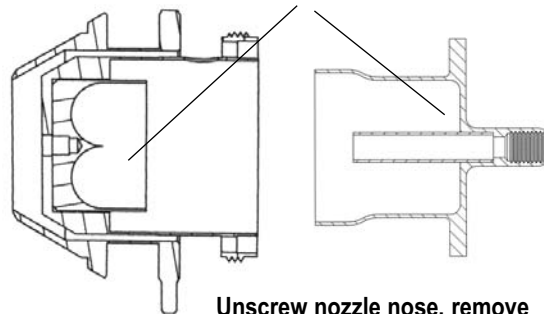

Unscrew nozzle nose, remove collector and unscrew tip.

Micro or Standard Tip
BE CAREFUL OF THREADS

Use STB7 brush to clean inside tube of collector assembly.

TIP ID WILL REQUIRE CLEANING TO INSURE PROPER RESULTS.

- A pin vise and various drill sizes are supplied for cleaning
- Be careful to use the correct cleaning drill for each tip
- Small micro tips are fragile. Broken tips will effect performance.

IT IS ADVISABLE TO HAVE SPARE TIPS

- When tips require cleaning they should be removed, replaced with new spare tips and cleaned at the end of the day.
- The replacement tip must be fully engaged to the collector thread.



MICRO TIPS

1015.11.127 (.09 x .06)
1015.11.136 (.074 x .042)
1015.11.134 (.050 x .025)

CLEANING DRILLS

9007.99.119 (.055 dia.)
9007.99.264 (.038 dia.)
9007.99.046 (.0225 dia.)



STANDARD TIPS

1015.11.121 (.188 x .125)
1015.11.122 (.125 x .089)

CLEANING DRILLS

9007.99.218 (.120 dia.)
9003.00.046 (.086 dia.)

1015.11.061 Standard Nozzle

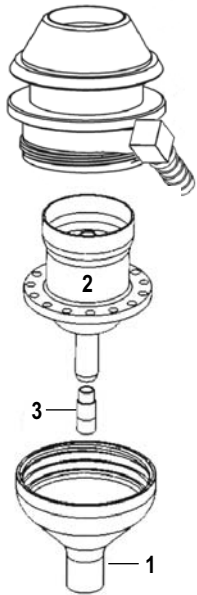

Item	Part No	Description
1	1015.11.102	Nose
2	1015.11.055	Collector Assembly
3	1015.11.121	Large Tip (.188 x .125)
3	1015.11.122	Medium Tip (.125 x .089)
4	0001.11.101	Filter Element
5	1022.02.040	Nozzle Handling Tool
6	9008.99.982	Pliers
7	1015.11.113	Nozzle Stand
8	STB7	Brush
9	9008.99.984	Pin Vise (.05 - .125)
10	9003.00.100	Cleaning Drill (.086 dia.)
11	9007.99.080	Cleaning Drill (.120 dia.)
12	9001.15.031	Cond. Silicone Hose - 21.75"
13	9001.15.031	Cond. Silicone Hose - 12.5"
14	9001.00.184	Elbow <i>Packaged Separately</i>
15	0025.04.101	Clip <i>Packaged Separately</i>
16	9000.33.005	Tape

Standard Nozzle Kit 1015.11.013

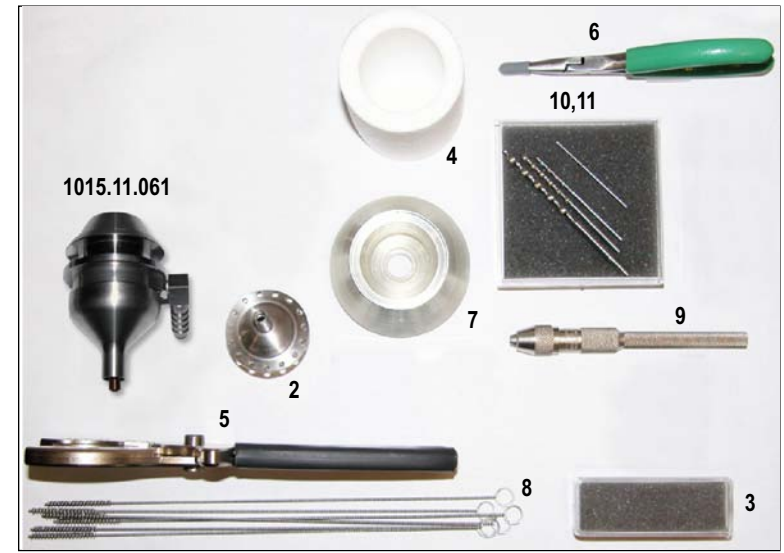

CLEANING INSTRUCTIONS

CAUTION: NOZZLE IS HOT DURING OPERATION. NOZZLE MUST BE COOL BEFORE DISASSEMBLY & CLEANING



Remove nozzle from DRS using nozzle handling tool and place in nozzle stand when not in use and prior to cleaning.

Any solder accumulation on the flat surface can be scraped off.

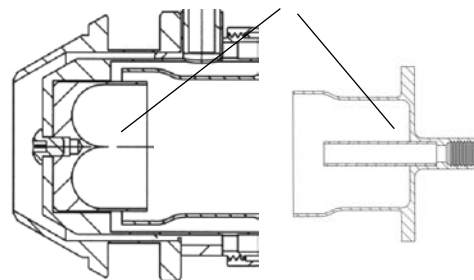

Unscrew nozzle nose, remove collector and unscrew tip.

Standard Tip

BE CAREFUL OF THREADS

Use STB7 brush to clean inside tube of collector assembly.



STANDARD TIPS
1015.11.121 (.188 x .125)
1015.11.122 (.125 x .089)

CLEANING DRILLS
9007.99.218 (.120 dia.)
9003.00.046 (.086 dia.)

TIP ID WILL REQUIRE CLEANING TO INSURE PROPER RESULTS.

- A pin vise and various drill sizes are supplied for cleaning
- Be careful to use the correct cleaning drill for each tip
- Small tips are fragile. Broken tips will effect performance.

IT IS ADVISABLE TO HAVE SPARE TIPS

- When tips require cleaning they should be removed, replaced with new spare tips and cleaned at the end of the day.
- The replacement tip must be fully engaged to the collector thread.

1015.11.063 Micro Nozzle

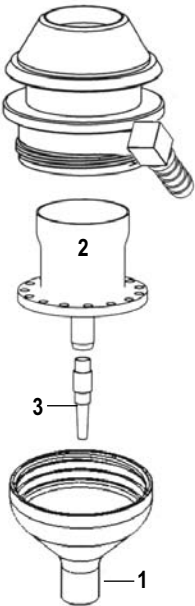

Item	Part No	Description
1	1015.11.102	Nose
2	1015.11.057	Collector Assembly
3	1015.11.127	Micro Tip (.09 x .06)
3	1015.11.136	Micro Tip (.074 x .042)
3	1015.11.134	Micro Tip (.05 x .025)
4	0001.11.101	Filter Element
5	1022.02.040	Nozzle Handling Tool
6	9008.99.982	Pliers
7	1015.11.113	Nozzle Stand
8	STB7	Brush
9	9008.99.983	Pin Vise (.0 - .04)
10	9008.99.984	Pin Vise (.05 - .125)
11	9007.99.046	Cleaning Drill (.0225 dia.)
12	9007.99.264	Cleaning Drill (.038 dia.)
13	9007.99.119	Cleaning Drill (.055 dia.)
14	9001.15.031	Cond. Silicone Hose - 21.75"
15	9001.15.031	Cond. Silicone Hose - 12.5"
16	9001.00.184	Elbow
17	0025.04.101	Clip Packaged Separately
18	9000.33.005	Tape Packaged Separately

Micro Nozzle Kit 1015.11.016

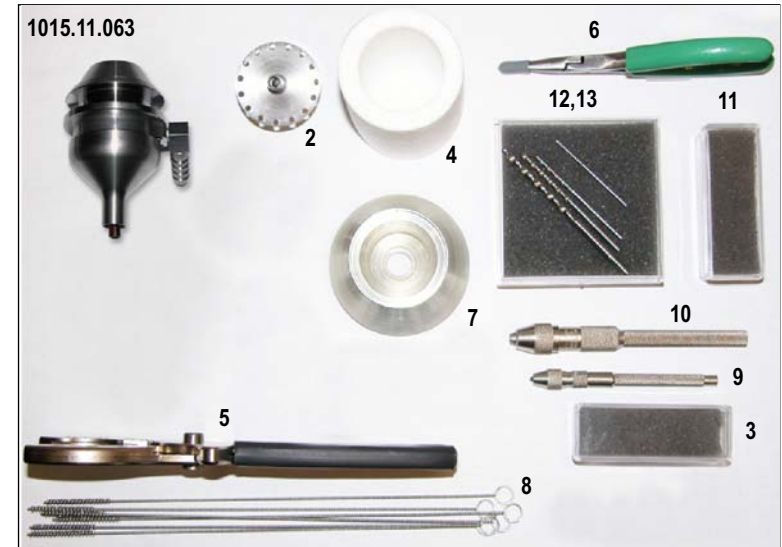

CLEANING INSTRUCTIONS

CAUTION: NOZZLE IS HOT DURING OPERATION. NOZZLE MUST BE COOL BEFORE DISASSEMBLY & CLEANING



Remove nozzle from DRS using nozzle handling tool and place in nozzle stand when not in use and prior to cleaning.

Any solder accumulation on the flat surface can be scraped off.

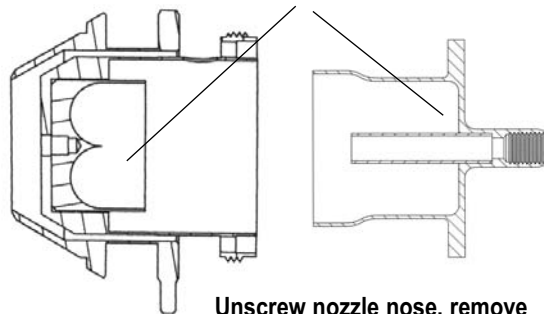

Unscrew nozzle nose, remove collector and unscrew tip.

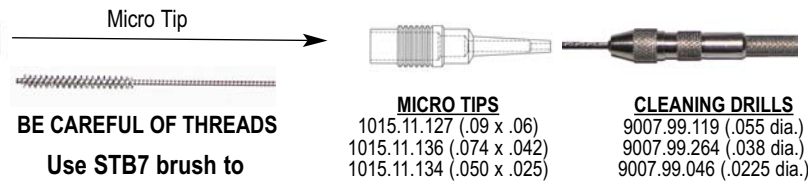

BE CAREFUL OF THREADS

Use STB7 brush to clean inside tube of collector assembly.

TIP ID WILL REQUIRE CLEANING TO INSURE PROPER RESULTS.

- A pin vise and various drill sizes are supplied for cleaning
- Be careful to use the correct cleaning drill for each tip
- Small micro tips are fragile. Broken tips will effect performance.

IT IS ADVISABLE TO HAVE SPARE TIPS

- When tips require cleaning they should be removed, replaced with new spare tips and cleaned at the end of the day.
- The replacement tip must be fully engaged to the collector thread.

MICRO TIPS
 1015.11.127 (.09 x .06)
 1015.11.136 (.074 x .042)
 1015.11.134 (.050 x .025)

CLEANING DRILLS
 9007.99.119 (.055 dia.)
 9007.99.264 (.038 dia.)
 9007.99.046 (.0225 dia.)